

EL PASO COUNTY - COLORADO6317114015
6135 BRIARCLIFF RDTotal Market Value
\$390,770**OVERVIEW**

Owner:	SCHAUER CHERYL L
Mailing Address:	6135 BRIARCLIFF RD COLORADO SPRINGS CO, 80918-3318
Location:	6135 BRIARCLIFF RD
Tax Status:	Taxable
Zoning:	R1-6 HS
Plat No:	4004
Legal Description:	LOT 16 BLK 3 ERINDALE SUB FIL NO 6

MARKET & ASSESSMENT DETAILS

	2019 Market Value	2019 Assessed Value
Land	\$71,500	\$5,110
Improvement	\$319,270	\$22,830
Total	\$390,770	\$27,940

RESIDENTIAL - RANCH (1)

Market Value \$319,270

Assessment Rate	7.15	Above Grade Area	1,698
Bldg #	1	First Floor Area	1,698
Style Description	RANCH	Above First Floor Area	0
Property Description	FRAME GOOD QUALITY	Lower Level Living Area	0
Year Built	1997	Total Basement Area	1,296
Dwelling Units	1	Finished Basement Area	612
Number of Rooms	7	Garage Description	Multiple Types
Number of Bedrooms	3	Garage Area	624
Number of Baths	1.50	Carport Area	-

LAND DETAILS

Sequence Number	Land Use	Assessment Rate	Area	Market Value
1	SINGLE FAMILY RES.	7.150	12800 SQFT	\$71,500

SALES HISTORY

	Sale Date	Sale Price	Sale Type	Reception
+	05/19/2016	\$370,000	Good sale	216053840
+	05/01/2006	\$395,000	Good sale	206062727
+	03/03/1997	\$54,900	Good sale	97022955
+	01/26/1995	\$46,000	Good sale	95008942

TAX ENTITY AND LEVY INFORMATION

County Treasurer Tax Information

Tax Area Code: **FBY** Levy Year: **2018** Mill Levy: **73.375**

Taxing Entity	Levy	Contact Name/Organization	Contact Phone
EL PASO COUNTY	7.738	FINANCIAL SERVICES	(719) 520-6498
EPC ROAD & BRIDGE SHARE	0.165	-	(719) 520-6498
CITY OF COLORADO SPRINGS	4.279	CITY OF CS-CFO	(719) 385-5224
EPC-COLORADO SPGS ROAD & BRIDGE SHARE	0.165	-	(719) 520-6498
COLO SPGS SCHOOL NO 11	56.084	GLENN GUSTAFSON	(719) 520-2010
PIKES PEAK LIBRARY	4.000	MIKE VARNET	(719) 531-6333
SOUTHEASTERN COLO WATER CONSERVANCY	0.944	JAMES BRODERICK	(719) 948-2400
EL PASO COUNTY CONSERVATION	0.000	PAMELA DAVISON	(719) 632-9598

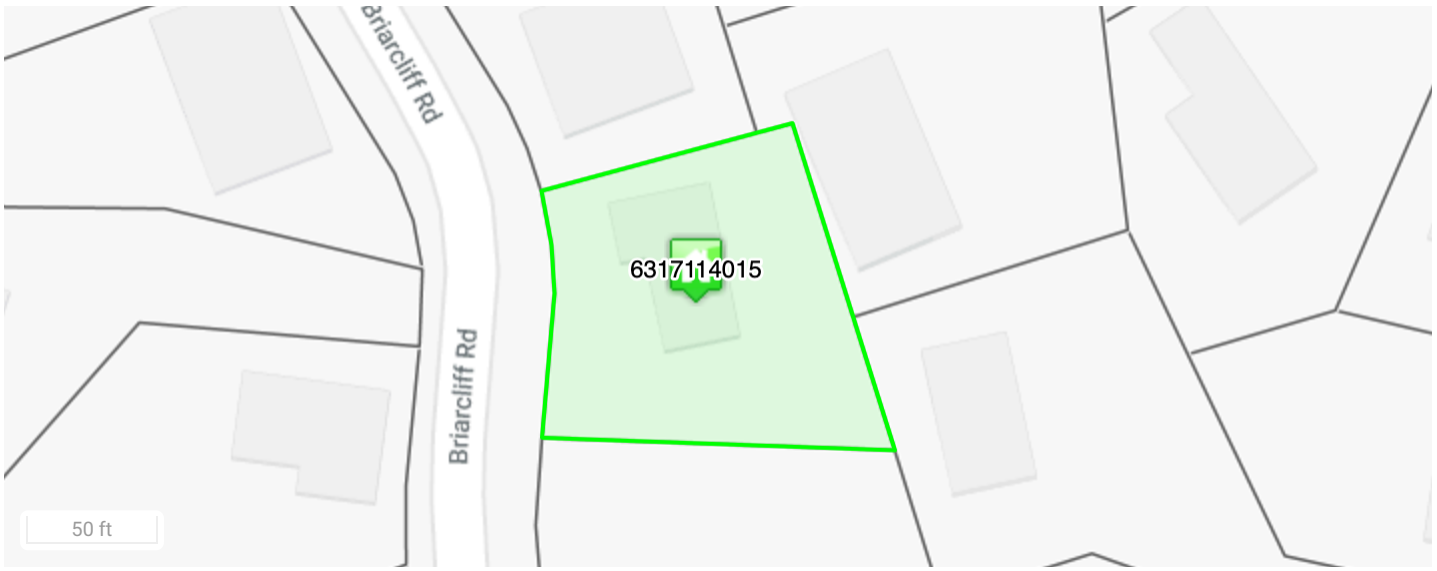

Disclaimer

We have made a good-faith effort to provide you with the most recent and most accurate information available. However, if you need to use this information in any legal or official venue, you will need to obtain official copies from the Assessor's Office. Do be aware that this data is subject to change on a daily basis. If you believe that any of this information is incorrect, please call us at (719) 520-6600.