

EL PASO COUNTY - COLORADO5332229019
3115 PELICAN GRVTotal Market Value
\$196,788**OVERVIEW**

Owner:	CRAWFORD RYAN, CRAWFORD PAIGE
Mailing Address:	3115 PELICAN GRV COLORADO SPRINGS CO, 80922-5209
Location:	3115 PELICAN GRV
Tax Status:	Taxable
Zoning:	PUD AO
Plat No:	10453
Legal Description:	LOT 13 THE CASCADES AT SPRINGS RANCH FIL NO 5

MARKET & ASSESSMENT DETAILS

	2018 Market Value	2018 Assessed Value
Land	\$33,600	\$2,420
Improvement	\$163,188	\$11,750
Total	\$196,788	\$14,170

RESIDENTIAL - TWO STORY (1)Market Value **\$163,188**

Assessment Rate	7.20	Above Grade Area	1,638
Bldg #	1	First Floor Area	662
Style Description	TWO STORY	Above First Floor Area	976
Property Description	FRAME AVERAGE QUALITY	Lower Level Living Area	0
Year Built	2000	Total Basement Area	378
Dwelling Units	1	Finished Basement Area	
Number of Rooms	6	Garage Description	Built-In
Number of Bedrooms	3	Garage Area	409
Number of Baths	2.50	Carport Area	-

LAND DETAILS

Sequence Number	Land Use	Assessment Rate	Area	Market Value
1	SINGLE FAMILY RES.	7.200	3690 SQFT	\$33,600

SALES HISTORY

	Sale Date	Sale Price	Sale Type	Reception
+	05/21/2014	\$0	-	214043035
+	05/12/2014	\$179,900	Good sale	214039689
+	11/19/2003	\$0	-	203272420
+	09/19/2003	\$0	-	203220338
+	09/19/2003	\$162,900	Good sale; Trade or exchange	203220339
+	03/23/2001	\$144,185	Good sale	201034981
+	12/31/1999	\$760,233	Multiple properties	99195071
+	12/17/1999	\$0	-	99188962

TAX ENTITY AND LEVY INFORMATION

County Treasurer Tax Information

Tax Area Code: **SDG** Levy Year: **2018** Mill Levy: **60.335**

Taxing Entity	Levy	Contact Name/Organization	Contact Phone
EL PASO COUNTY	7.738	FINANCIAL SERVICES	(719) 520-6498
EPC ROAD & BRIDGE SHARE	0.165	-	(719) 520-6498
CITY OF COLORADO SPRINGS	4.279	CITY OF CS-CFO	(719) 385-5224
EPC-COLORADO SPGS ROAD & BRIDGE SHARE	0.165	-	(719) 520-6498
EL PASO COUNTY SCHOOL NO 49	43.044	BRETT RIDGWAY	(719) 495-1130
PIKES PEAK LIBRARY	4.000	MIKE VARNET	(719) 531-6333
SOUTHEASTERN COLO WATER CONSERVANCY	0.944	JAMES BRODERICK	(719) 948-2400
CENTRAL COLORADO CONSERVATION	0.000	PAMELA DAVISON	(719) 473-7104

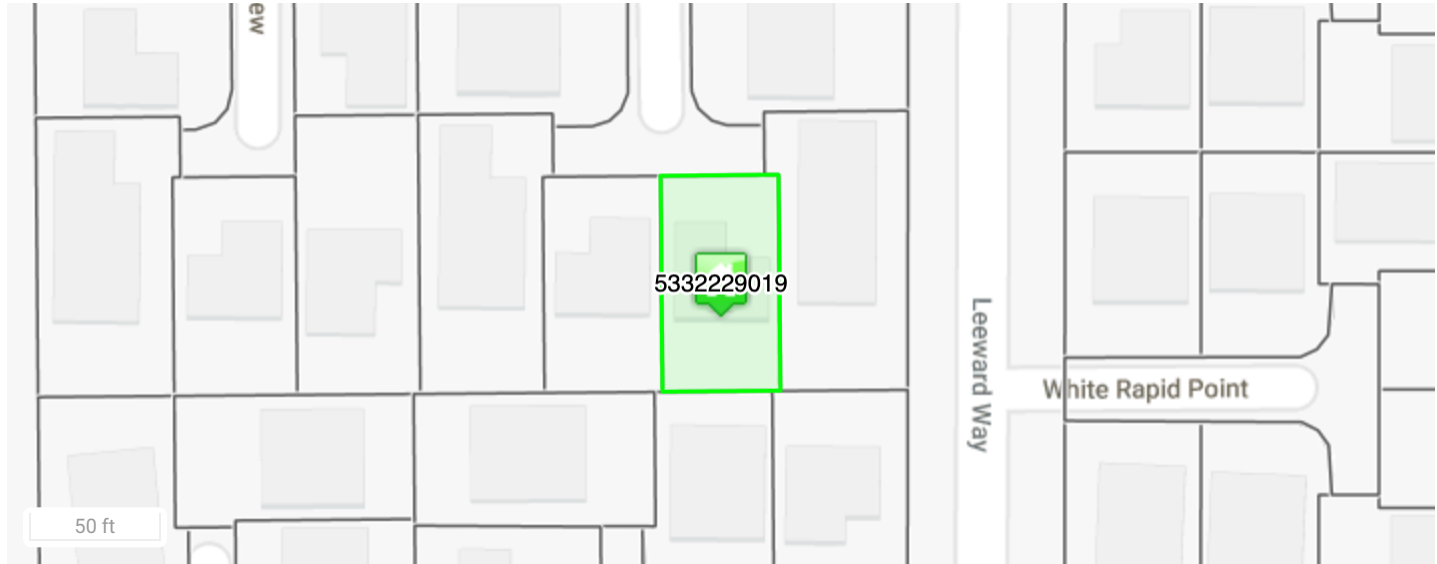

Disclaimer

We have made a good-faith effort to provide you with the most recent and most accurate information available. However, if you need to use this information in any legal or official venue, you will need to obtain official copies from the Assessor's Office. Do be aware that this data is subject to change on a daily basis. If you believe that any of this information is incorrect, please call us at (719) 520-6600.